

State of S<sup>c</sup> Carolina Pursuant to a warrant from John Thomas Esq<sup>r</sup> Com<sup>r</sup> of locations, dated 14<sup>th</sup> May 1794, I have admeasured and laid out unto William Gillihan a tract of two hundred acres of land on the County, as soldier in the 5<sup>th</sup> Regiment, situate in Greenville County on both sides of a small branch of the Saluda river, bounded S. by a line running S. 66<sup>o</sup> 4' W. by land laid out for John Gowin, N. E. by a line running S. 45<sup>o</sup> 8' E. by land laid out for Thomas Brown, all other sides on vacant land, and hath such shapes and marks as the above Plat represents.  
Survey: 14<sup>th</sup> May 1794, George Salmon, D.  
Recorded 2<sup>d</sup> Sept<sup>r</sup> 1794

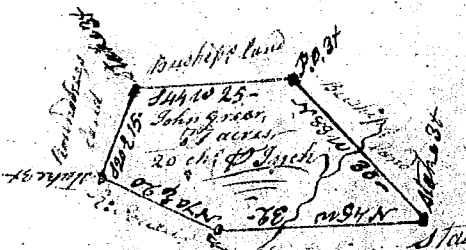

State of S<sup>c</sup> Carolina Pursuant to a warrant from John Thomas Esq<sup>r</sup> Com<sup>r</sup> of loc<sup>s</sup>, I have laid out unto John Grear a tract of two hundred & sixty six acres of land in Sixty six District S<sup>c</sup> side of Broad river, on Buffels Creek & hath such shapes forms marks, buttings & boundings as the above Plat represents.  
Survey: 14<sup>th</sup> Sept<sup>r</sup> 1794, Charles Sims, D.  
Recorded 3<sup>d</sup> Sept<sup>r</sup> 1794, Del. self.

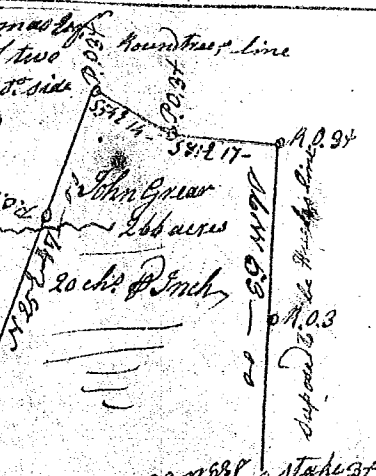

Pursuant to a warrant from John Thomas Esq<sup>r</sup> Com<sup>r</sup> of locations, I have admeasured and laid out unto John Grear a tract of seventy seven acres of land in Sixty six District South side of Broad river in a branch of Buffels Creek, and hath such shape, forms, marks, buttings & boundings as the above Plat represents.  
Survey: 8<sup>th</sup> day Sept<sup>r</sup> 1794, Charles Sims, D.  
Recorded 3<sup>d</sup> Sept<sup>r</sup> 1794, Del. self.

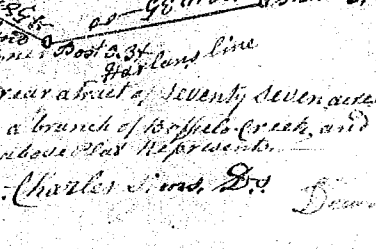

State of South Carolina Pursuant to a warrant from John Thomas Esq<sup>r</sup> Com<sup>r</sup> of loc<sup>s</sup> 96 district of Saluda dated the 18<sup>th</sup> April 1794, I have admeasured and laid out unto Mary Murphy one hundred & three acres of land in said district on a branch of Terbins Creek waters of Broad river running N. W. & N. E. with John Murphys land N. W. with James Wofford's land E. with M. G. Gethers land, all other sides by vacant land, and hath such shape and marks as the above Plat represents.  
Survey: 19<sup>th</sup> April 1794, Jas<sup>s</sup> Wofford D.  
Recorded 5<sup>th</sup> Sept<sup>r</sup> 1794, Del. self.

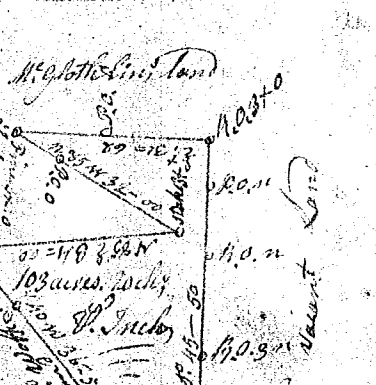

South Carolina Pursuant to a warrant from John Thomas Esq<sup>r</sup> Com<sup>r</sup> of loc<sup>s</sup> in 96 District of Saluda, dated the 1<sup>st</sup> day of July 1794, I have admeasured and laid out unto Solomon Cole a tract of one hundred and six acres of land in said district on the branches of Bourides Creek, waters of Mcborns Creek & ready river bounding by a line running N. E. by Joseph Babbs and William Bourides N. W. by John Harveys, S. W. by a line running of W. F. Adwell, and hath such shape form & marks as the above Plat represents.  
Survey: 5<sup>th</sup> July 1794, John Rodgers D.  
Recorded 7<sup>th</sup> Sept<sup>r</sup> 1794, Del. W. Adwell.

